

Stemin Machinefabriek b.v.
Hanzeweg 3 • 7241 CR Lochem
P.O. Box 32 • 7240 AA Lochem
The Netherlands
T (+) 31 (0) 573 25 20 43
F (+) 31 (0) 573 25 71 13
info@stemin.nl • www.stemin.nl



Timing-belt Pulleys - Inch/Taperbush



Inhoudsopgave

Table of Contents

Dimensies	L	Dimensions	3
			4
			5
Dimensies	H	Dimensions	6
			7
			8
			9
	XH		10

Wij behouden ons het recht op vermenigvuldiging, nadruk en vertalen voor. Maat- en constructiewijzigingen voorbehouden.

All rights of duplication, reprinting and translation are reserved. We reserve the right to modify dimensions and constructions without prior notice.

Drukwerk No. 02.02.12.433.08.02/02

Publication No. 02.02.12.433.08.02/02

Profiel - L

Profile - L

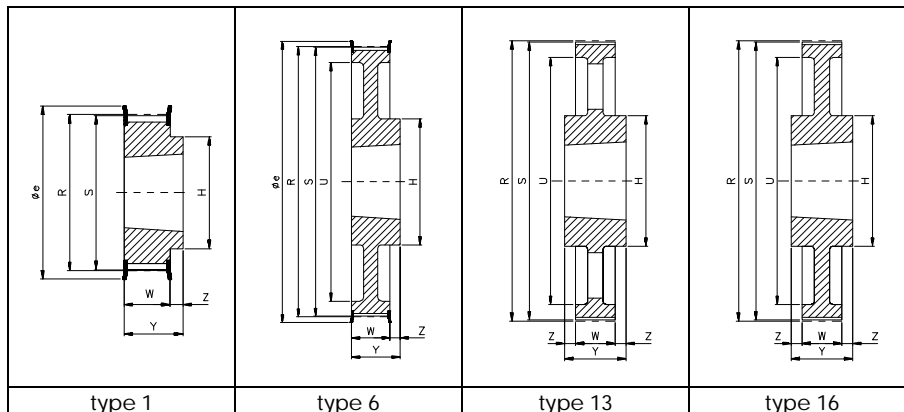

aantal tanden number of teeth	steek pitch	riem-breedte belt width	type	klembus bushing	D_p R Ø	S Ø	U Ø	e Ø	W	H Ø	Y	Z	flens flange	materiaal material
		(")			(mm)									
18	L	050	1	1108	54,57	53,81	-	62	19	47	22	3	a	e
19	L	050	1	1108	57,61	56,84	-	62	19	47	22	3	a	e
20	L	050	1	1108	60,64	59,88	-	67	19	48	22	3	a	e
21	L	050	1	1108	63,67	62,91	-	67	19	48	22	3	a	e
22	L	050	1	1108	68,70	65,94	-	73	19	51	22	3	a	e
23	L	050	1	1108	69,73	68,97	-	73	19	51	22	3	a	e
24	L	050	1	1108	72,77	72,01	-	80	19	58	22	3	a	e
25	L	050	1	1108	75,80	75,04	-	80	19	58	22	3	a	e
26	L	050	1	1108	78,83	78,07	-	88	19	58	22	3	a	e
27	L	050	1	1108	81,86	81,10	-	88	19	58	22	3	a	e
28	L	050	1	1108	84,89	84,13	-	94	19	58	22	3	a	e
30	L	050	1	1108	90,96	90,20	-	98	19	58	22	3	a	e
32	L	050	1	1108	97,02	96,26	-	100	19	58	22	3	a	e
36	L	050	6	1108	109,15	108,39	84	113	19	58	22	3	a	e
40	L	050	1	1610	121,28	120,52	-	129	19	90	25	6	a	e
44	L	050	6	1610	133,40	132,64	110	142	19	90	25	6	a	e
48	L	050	6	1610	145,53	144,77	126	151	19	90	25	6	a	e
60	L	050	16	1610	181,91	181,15	162	-	19	90	25	3	b	e
72	L	050	13	1610	218,30	217,54	199	-	19	90	25	3	b	e
84	L	050	13	1610	254,68	253,92	235	-	19	90	25	3	b	e
96	L	050	13	2012	291,06	290,30	270	-	19	110	32	6,5	b	e
120	L	050	13	2012	363,83	363,07	344	-	19	110	32	6,5	b	e

a = incl. / with	b = excl. / without	e = gietijzer / cast iron
------------------	---------------------	---------------------------

Profiel - L

Profile - L

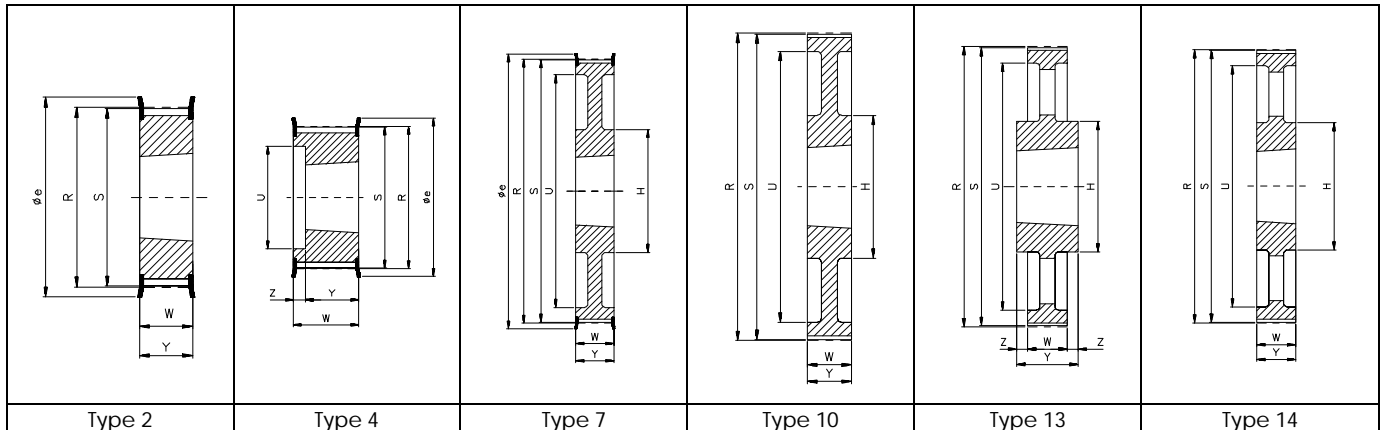

aantal tanden number of teeth	steek pitch	riem-breedte belt width	type	klembus bushing	D _p R Ø	S Ø	U Ø	e Ø	W	H Ø	Y	Z	flens flange	materiaal material
(mm)														
18	L	075	4	1108	54,57	53,81	38	62	25	-	22	3	a	e
19	L	075	4	1108	57,61	56,84	38	62	25	-	22	3	a	e
20	L	075	4	1108	60,64	59,88	46	67	25	-	22	3	a	e
21	L	075	4	1108	63,67	62,91	46	67	25	-	22	3	a	e
22	L	075	4	1108	68,70	65,94	46	73	25	-	22	3	a	e
23	L	075	4	1108	69,73	68,97	46	73	25	-	22	3	a	e
24	L	075	4	1108	72,77	72,01	53	80	25	-	22	3	a	e
25	L	075	4	1108	75,80	75,04	53	80	25	-	22	3	a	e
26	L	075	4	1108	78,83	78,07	60	88	25	-	22	3	a	e
27	L	075	4	1108	81,86	81,10	60	88	25	-	22	3	a	e
28	L	075	4	1108	84,89	84,13	65	94	25	-	22	3	a	e
30	L	075	4	1108	90,96	90,20	68	98	25	-	22	3	a	e
32	L	075	4	1108	97,02	96,26	76	100	25	-	22	3	a	e
36	L	075	2	1610	109,15	108,39	-	113	25	-	25	-	a	e
40	L	075	2	1610	121,28	120,52	-	129	25	-	25	-	a	e
44	L	075	7	1610	133,40	132,64	110	142	25	90	25	-	a	e
48	L	075	7	1610	145,53	144,77	126	151	25	90	25	-	a	e
60	L	075	10	1610	181,91	181,15	162	-	25	90	25	-	b	e
72	L	075	14	1610	218,30	217,54	199	-	25	90	25	-	b	e
84	L	075	13	2012	254,68	253,92	235	-	25	110	32	3,5	b	e
96	L	075	13	2012	291,06	290,30	270	-	25	110	32	3,5	b	e
120	L	075	13	2012	363,83	363,07	344	-	25	110	32	3,5	b	e

a = incl. / with	b = excl. / without	e = gietijzer / cast iron
------------------	---------------------	---------------------------

Profiel - L

Profile - L

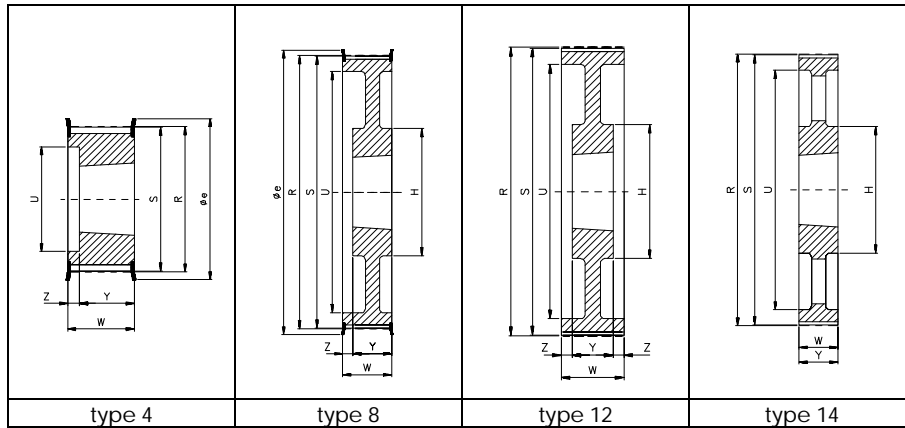

aantal tanden number of teeth	steek pitch	riem-breedte belt width	type	klembus bushing	D _p R Ø	S Ø	U Ø	e Ø	W	H Ø	Y	Z	flens flange	materiaal material
(mm)														
18	L	100	4	1108	54,57	53,81	38	62	32	-	22	10	a	e
19	L	100	4	1108	57,61	56,84	38	62	32	-	22	10	a	e
20	L	100	4	1108	60,64	59,88	46	67	32	-	22	10	a	e
21	L	100	4	1108	63,67	62,91	46	67	32	-	22	10	a	e
22	L	100	4	1108	68,70	65,94	46	73	32	-	22	10	a	e
23	L	100	4	1108	69,73	68,97	46	73	32	-	22	10	a	e
24	L	100	4	1108	72,77	72,01	53	80	32	-	22	10	a	e
25	L	100	4	1108	75,80	75,04	53	80	32	-	22	10	a	e
26	L	100	4	1108	78,83	78,07	60	88	32	-	22	10	a	e
27	L	100	4	1108	81,86	81,10	60	88	32	-	22	10	a	e
28	L	100	4	1108	84,89	84,13	65	94	32	-	22	10	a	e
30	L	100	4	1210	90,96	90,20	68	98	32	-	25	7	a	e
32	L	100	4	1210	97,02	96,26	76	100	32	-	25	7	a	e
36	L	100	4	1610	109,15	108,39	85	113	32	-	25	7	a	e
40	L	100	4	1610	121,28	120,52	100	129	32	-	25	7	a	e
44	L	100	8	1610	133,40	132,64	110	142	32	90	25	7	a	e
48	L	100	8	1610	145,53	144,77	126	151	32	90	25	7	a	e
60	L	100	12	1610	181,91	181,15	162	-	32	90	25	3,5	b	e
72	L	100	14	2012	218,30	217,54	199	-	32	110	32	-	b	e
84	L	100	14	2012	254,68	253,92	235	-	32	110	32	-	b	e
96	L	100	14	2012	291,06	290,30	270	-	32	110	32	-	b	e
120	L	100	14	2012	363,83	363,07	344	-	32	110	32	-	b	e

a = incl. / with	b = excl. / without	e = gietijzer / cast iron
------------------	---------------------	---------------------------

Profiel - H

Profile - H

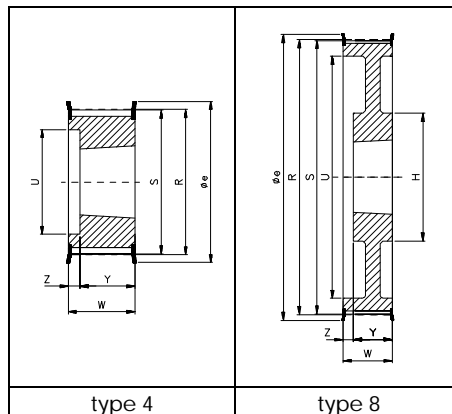

aantal tanden number of teeth	steek pitch	riem-breedte belt width	type	klembus bushing	R Ø	S Ø	U Ø	e Ø	W	H Ø	Y	Z	flens flange	materiaal material
		(")			(mm)									
14	H	100	4	1108	56,60	55,23	37	62	31	-	22	9	a	e
16	H	100	4	1108	64,68	63,31	46	67	31	-	22	9	a	e
18	H	100	4	1108	72,77	71,40	56	80	31	-	25	6	a	e
19	H	100	4	1210	76,81	75,44	56	84	31	-	25	6	a	e
20	H	100	4	1210	80,85	79,48	56	88	31	-	25	6	a	e
21	H	100	4	1210	84,89	83,52	62	94	32	-	25	7	a	e
22	H	100	4	1210	88,94	87,57	62	94	32	-	25	7	a	e
23	H	100	4	1210	92,98	91,61	71	98	32	-	25	7	a	e
24	H	100	4	1210	97,02	95,65	71	104	32	-	25	7	a	e
25	H	100	4	1610	101,06	99,69	78	104	32	-	25	7	a	e
26	H	100	4	1610	105,11	103,74	78	108	32	-	25	7	a	e
27	H	100	4	1610	109,15	107,78	86	113	32	-	25	7	a	e
28	H	100	4	1610	113,19	111,92	86	118	32	-	25	7	a	e
30	H	100	4	1610	121,28	119,91	95	129	32	-	25	7	a	e
32	H	100	8	1610	129,36	127,99	110	137	32	82	25	7	a	e
36	H	100	8	1610	145,53	144,16	120	151	32	82	25	7	a	e
40	H	100	8	1610	161,70	160,33	136	168	32	82	25	7	a	e
44	H	100	8	2012	177,87	176,50	162	191	32	110	32	-	a	e
48	H	100	8	2012	194,04	192,67	168	199	32	110	32	-	a	e
60	H	100	8	2012	242,55	241,18	217	-	34	110	32	1	b	e
72	H	100	8	2012	291,06	289,69	264	-	34	110	32	1	b	e
84	H	100	8	2012	339,57	338,20	312	-	34	110	32	1	b	e
96	H	100	8	2517	388,08	386,71	357	-	34	120	45	5,5	b	e
120	H	100	8	2517	485,10	483,73	457	-	34	120	45	5,5	b	e

a = incl. / with

b = excl. / without

e = gietijzer / cast iron

Profiel - H

Profile - H

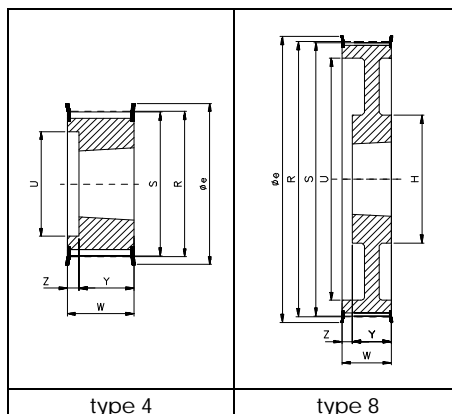

aantal tanden number of teeth	steek pitch	riem-breedte belt width	type	klembus bushing	R Ø	S Ø	U Ø	e Ø	W	H Ø	Y	Z	flens flange	materiaal material
		(")			(mm)									
14	H	150	4	1108	56,60	55,23	37	62	45	-	22	23	a	e
16	H	150	4	1108	64,68	63,31	46	67	45	-	22	23	a	e
18	H	150	4	1108	72,77	71,40	56	80	45	-	25	20	a	e
19	H	150	4	1210	76,81	75,44	56	84	45	-	25	20	a	e
20	H	150	4	1210	80,85	79,48	56	88	45	-	25	20	a	e
21	H	150	4	1210	84,89	83,52	62	94	45	-	25	20	a	e
22	H	150	4	1210	88,94	87,57	62	94	45	-	25	20	a	e
23	H	150	4	1210	92,98	91,61	71	98	45	-	25	20	a	e
24	H	150	4	1210	97,02	95,65	71	104	45	-	25	20	a	e
25	H	150	4	1610	101,06	99,69	78	104	45	-	25	20	a	e
26	H	150	4	1610	105,11	103,74	78	108	45	-	25	20	a	e
27	H	150	4	1610	109,15	107,78	86	113	45	-	25	20	a	e
28	H	150	4	1610	113,19	111,92	86	118	45	-	25	20	a	e
30	H	150	4	1610	121,28	119,91	95	129	45	-	25	20	a	e
32	H	150	8	1610	129,36	127,99	110	137	45	82	25	20	a	e
36	H	150	8	1610	145,53	144,16	120	151	45	82	25	20	a	e
40	H	150	8	1610	161,70	160,33	136	168	45	82	25	20	a	e
44	H	150	8	2012	177,87	176,50	162	191	45	110	32	13	a	e
48	H	150	8	2012	194,04	192,67	168	199	45	110	32	7	a	e
60	H	150	8	2012	242,55	241,18	217	-	46	110	32	7	b	e
72	H	150	8	2012	291,06	289,69	264	-	46	110	32	7	b	e
84	H	150	8	2012	339,57	338,20	312	-	46	110	32	7	b	e
96	H	150	8	2517	388,08	386,71	357	-	46	120	45	0,5	b	e
120	H	150	8	2517	485,10	483,73	457	-	46	120	45	0,5	b	e

a = incl. / with

b = excl. / without

e = gietijzer / cast iron

Profiel - H

Profile - H

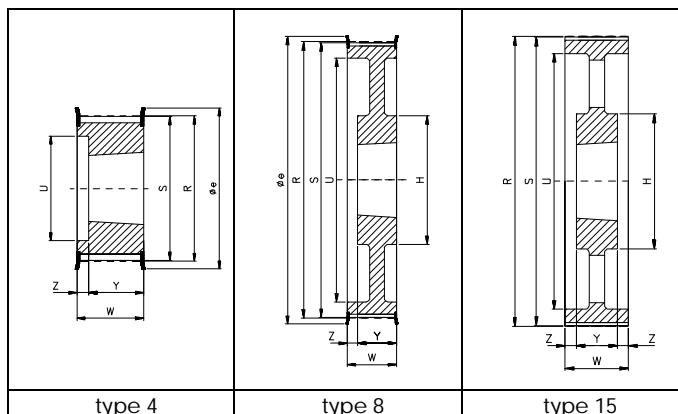

aantal tanden number of teeth	steek pitch	riem-breedte belt width	type	klembus bushing	R Ø	S Ø	U Ø	e Ø	W	H Ø	Y	Z	flens flange	materiaal material
		(")			(mm)									
16	H	200	4	1108	64,68	63,31	46	67	58	-	22	36	a	e
18	H	200	4	1210	72,77	71,40	52	80	58	-	25	33	a	e
19	H	200	4	1610	76,81	75,44	56	84	58	-	25	33	a	e
20	H	200	4	1610	80,85	79,48	56	88	58	-	25	33	a	e
21	H	200	4	1610	84,89	83,52	67	94	58	-	25	33	a	e
22	H	200	4	1610	88,94	87,57	67	94	58	-	25	33	a	e
23	H	200	4	1610	92,98	91,61	71	98	58	-	25	33	a	e
24	H	200	4	1610	97,02	95,65	71	104	58	-	25	33	a	e
25	H	200	4	1610	101,06	99,69	78	104	58	-	25	33	a	e
26	H	200	4	1610	105,11	103,74	78	108	58	-	25	33	a	e
27	H	200	4	1610	109,15	107,78	86	113	58	-	25	33	a	e
28	H	200	4	1610	113,19	111,92	86	118	58	-	25	33	a	e
30	H	200	4	1610	121,28	119,91	95	129	58	-	25	33	a	e
32	H	200	4	1610	129,36	127,99	110	137	58	-	32	26	a	e
36	H	200	8	2012	145,53	144,16	120	151	58	102	32	26	a	e
40	H	200	8	2012	161,70	160,33	136	168	58	110	32	26	a	e
44	H	200	8	2012	177,87	176,50	162	191	58	110	32	26	a	e
48	H	200	8	2012	194,04	192,67	168	199	58	120	45	13	a	e
60	H	200	15	2517	242,55	241,18	217	-	60	120	45	7,5	a	e
72	H	200	15	2517	291,06	289,69	264	-	60	120	45	7,5	b	e
84	H	200	15	2517	339,57	338,20	312	-	60	120	45	7,5	b	e
96	H	200	15	2517	388,08	386,71	357	-	60	120	45	7,5	b	e
120	H	200	15	2517	485,10	483,73	457	-	60	120	45	7,5	b	e

a = incl. / with

b = excl. / without

e = gietijzer / cast iron

Profiel - H

Profile - H

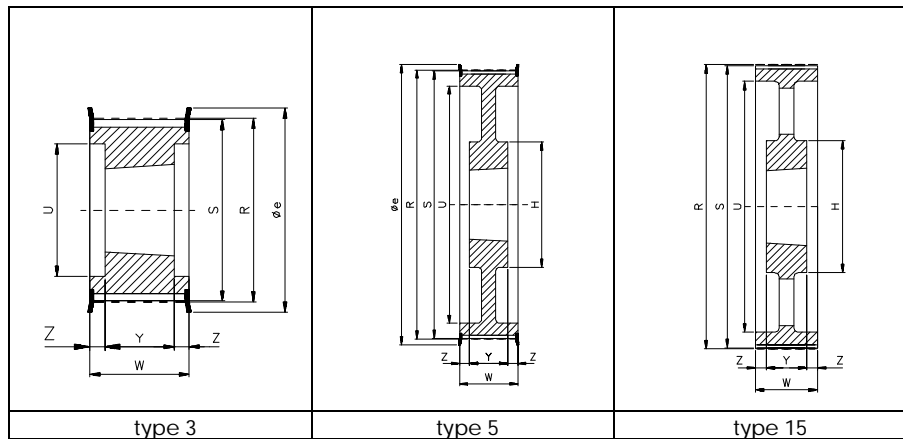

aantal tanden number of teeth	steek pitch	riem-breedte belt width	type	klembus bushing	R Ø	S Ø	U Ø	e Ø	W	H Ø	Y	Z	flens flange	materiaal material
		(")			(mm)									
19	H	300	3	1215	76,81	75,44	56	84	84	-	38	23	a	e
20	H	300	3	1615	80,85	79,48	65	88	84	-	38	23	a	e
21	H	300	3	1615	84,89	83,52	65	94	84	-	38	23	a	e
22	H	300	3	1615	88,94	87,57	65	94	84	-	38	23	a	e
23	H	300	3	1615	92,98	91,61	71	98	84	-	38	23	a	e
24	H	300	3	1615	97,02	95,65	71	104	84	-	38	23	a	e
25	H	300	3	1615	101,06	99,69	79	104	84	-	38	23	a	e
26	H	300	3	1615	105,11	103,74	79	108	84	-	38	23	a	e
27	H	300	3	2012	109,15	107,78	86	113	84	-	32	26	a	e
28	H	300	3	2012	113,19	111,92	86	118	84	-	32	26	a	e
30	H	300	3	2012	121,28	119,91	95	129	84	-	32	26	a	e
32	H	300	3	2517	129,36	127,99	110	137	84	-	45	19,5	a	e
36	H	300	3	2517	145,53	144,16	120	151	84	-	45	19,5	a	e
40	H	300	5	2517	161,70	160,33	136	168	84	120	45	19,5	a	e
44	H	300	5	2517	177,87	176,50	162	191	86	120	45	20,5	a	e
48	H	300	5	2517	194,04	192,67	168	199	86	120	45	20,5	a	e
60	H	300	15	2517	242,55	241,18	223	-	86	120	45	20,5	b	e
72	H	300	15	2517	291,06	289,69	267	-	86	120	45	20,5	b	e
84	H	300	15	2517	339,57	338,20	312	-	86	120	45	20,5	b	e
96	H	300	15	3030	388,08	386,71	357	-	86	146	76	5	b	e
120	H	300	15	3030	485,10	483,73	457	-	86	146	76	5	b	e

a = incl. / with

b = excl. / without

e = gietijzer / cast iron

